

## PL-BRICK HP 2850-730 2X6 IP G2

PrevaLED BRICK HP IP G2 | LED modules for industry and outdoor applications



### Product family features

- Module efficacy: up to 191 lm/W
- Available with color temperature: 2,200 K, 2,700 K, 3,000 K and 4000 K
- Color rendering index  $R_a$ : > 70
- Initial color consistency:  $\leq 5$  SDCM
- Average lifetime (L80 B10): up to 100,000 h (temperature up to  $T_c = 85^\circ\text{C}$ )
- Geometry according to Zhaga Book 19
- Compatible to optics with IP solution, e.g. Ledil STRADA-IP-2x6 series

### Product family benefits

- 5 years system guarantee (with OPTOTRONIC control gear)
- Available with a wide range of lengths and color rendering index
- Available in four different color temperatures
- High module efficacy: up to 191 lm/W
- Optimally paired with OPTOTRONIC constant current LED drivers
- Extra-long lifetime – 100,000 hours (L80B10)
- Consistent white light: 5 SDCM
- Dimensions aligned with Zhaga book 19



## Product datasheet

---

### Areas of application

- Area illumination for Highbay light for industry and outdoor application
- Highbay lighting
- Street and area lighting
- Outdoor application
- Street and urban lighting

Nominal current	07 A
Type of current	DC
Nominal voltage	340 V
On-mode power	23.80 W
Energy consumption in on-mode	23.8 kWh/1000h

Luminous efficacy	163 lm/W
Color rendering index Ra	70
Correlated color temperature CCT	3000 K
Colour consistency (McAdam ellipses)	5
Useful luminous flux ( $\Phi_{\text{use}}$ )	3754 lm
Light color LED	White

Beam angle	0 °
Starting time	< 01 s
Warm-up time (60 %)	< 200 s

Number of LEDs per module	12
---------------------------	----

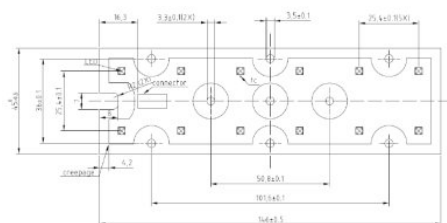

<b>Product weight</b>	4000 g
<b>Height</b>	8.0 mm
<b>Length</b>	146.0 mm

Product datasheet

Width	45.0 mm
-------	---------

Temperatures & operating conditions

Temperature range at storage	-30...85 °C
Maximum temperature at tc test point	85 °C
Ambient temperature range	-20...+70 °C
Performance temp. acc. to IEC 62717	55 °C

Lifespan

Number of switching cycles	100000
Lumen maintenance factor LMF	96
L70B50 lifetime	100000 h

Additional product data

Lighting technology used	LED
--------------------------	-----

Capabilities

Dimmable	Yes
----------	-----

Certificates & standards

Type of protection	IP20
Standards	CE
Energy efficiency class	D

Logistical data

Commodity code	85414100000
----------------	-------------



Environmental information

Information according Art. 33 of EU Regulation (EC) 1907/2006 (REACH)	
Date of Declaration	03-08-2023
Primary Article Identifier	4062172168519
Candidate List Substance 1	No declarable substances contained
Declaration No. in SCIP database	No declarable substances contained

Download Data

File
------

Product datasheet

	Certificates PL BRICK BA BAR CLE VDE ENEC 40045382 210723
	Declarations of conformity PL BRICK HP 2850 2x6 IP G2 CE 4231253 280720

Ecodesign regulation information:

Separate control gear and light sources must be disposed of at certified disposal companies in accordance with Directive 2012/19/EU (WEEE) in the EU and with Waste Electrical and Electronic Equipment (WEEE) Regulations 2013 in the UK. For this purpose, collection points for recycling centres and take-back systems (CRSO) are available from retailers or private disposal companies, which accept separate control gear and light sources free of charge. In this way, raw materials are conserved and materials are recycled.

Logistical Data

Product code	Product description	Packaging unit (Pieces/Unit)	Dimensions (length x width x height)	Volume	Gross weight
4062172168519	PL-BRICK HP 2850-730 2X6 IP G2	Shipping carton box 120	350 mm x 330 mm x 157 mm	18.13 dm <sup>3</sup>	5320.00 g

The mentioned product code describes the smallest quantity unit which can be ordered. One shipping unit can contain one or more single products. When placing an order, for the quantity please enter single or multiples of a shipping unit.

References / Links

\* For more information on the multi-level guarantee and the terms and conditions of the guarantee visit <https://www.inventronics-light.com/multilevel-guarantees>

Disclaimer

Subject to change without notice. Errors and omission excepted. Always make sure to use the most recent release.