

TYREinflate 200



Rapid Inflation Time

Inflate the tire to the desired pressure in ca. 4.5 minutes**



Wind-up Cable

Winding/unwinding mechanism for a neatly rolled up cable

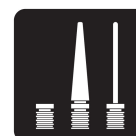

Including three-piece adaptor kit

To inflate bicycles, balls and other inflatables



Rapid tyre inflator with wind-up cable

The OSRAM Tyreinflate 200 analogue tyre inflator inflates a 13" tyre from flat in up to 4.5 minutes**. It has a large on/off button for easy use. Its stable design keeps the inflator still while in use. Powered from an in-car 12V socket, the Tyreinflate 200's long 3m power cable makes reaching all the tyres around the vehicles easier. Shows pressure readings in kPA, bar and PSI. Includes storage compartment for tyre valve caps when being used. Comes with three-piece adaptor set for use with bicycle tyres, motorcycle tyres, balls and other inflatables.**based on inflating a 13" tyre from flat to 2.41 BAR

Technical data

Product information

Order reference	OTI200
Inflation time	4.5 min
Max Pressure	5.5 bar
Air Hose Length	50 cm
Power Cord Length	3.0 m
Charge Time (h)	N/A
Display Size	50 mm
Measuring Units	PSI, kPa, bar
Accuracy (bar)	±0.1 bar
Flow rate (l/min)	tbc

Electrical data

Nominal wattage	120.00 W
Nominal voltage	11.1 V
Operating Voltage	12 V
Power Source	12 V Fused Plug

Dimensions & weight

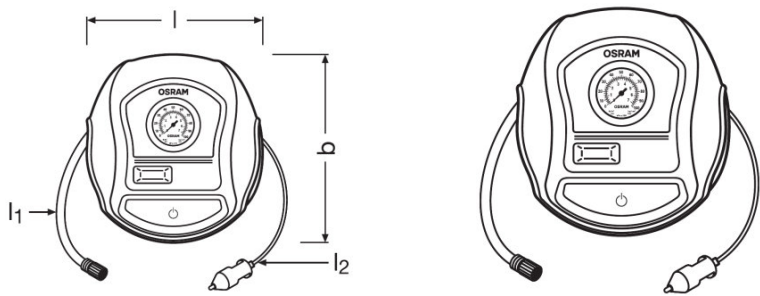

Length	197.0 mm
Width	79.0 mm
Height	180.0 mm

Additional product data

Display Type	Analogue
Noise Level (dB)	90 dB
Recommended to Use With	Car, Bicycle

Capabilities

Accessories	Adaptors for: Balls, Air Mattress, Bikes
Fuse	10 A

Country specific categorizations

Order reference	OTI200
-----------------	--------

Environmental information

Information according Art. 33 of EU Regulation (EC) 1907/2006 (REACH)	
Date of Declaration	07-03-2024
Primary Article Identifier	4052899620209
Candidate List Substance 1	Lead
CAS No. of substance 1	7439-92-1
Safe Use Instruction	The identification of the Candidate List substance is sufficient to allow safe use of the article.
Declaration No. in SCIP database	2c7125da-b121-4f3d-8c54-1fc45a571265



Detail



Detail



Detail

Product datasheet



Detail



Detail



Detail



Detail



Detail



Product Info Graphics



Product Info Graphics



Product Info Graphics



Product Info Graphics

Product datasheet

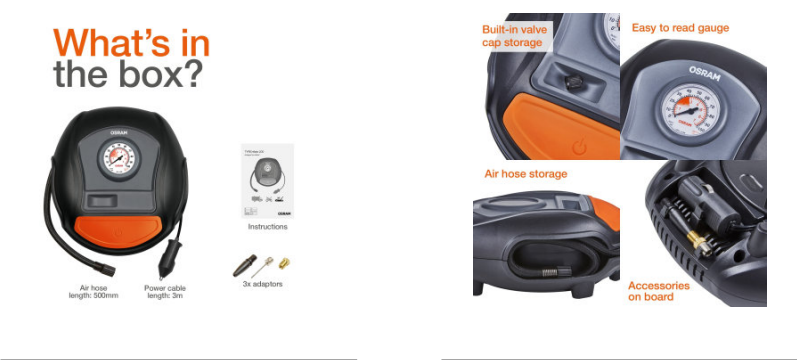

Product Info Graphics





Product Info Graphics

Logistical Data

Product code	Product description	Packaging unit (Pieces/Unit)	Dimensions (length x width x height)	Volume	Gross weight
4052899620209	TYRE inflate 200	Folding carton box 1	186 mm x 83 mm x 203 mm	3.13 dm ³	790.00 g
4062172166515	TYRE inflate 200	Shipping carton box 4	351 mm x 206 mm x 238 mm	17.21 dm ³	3462.00 g

The mentioned product code describes the smallest quantity unit which can be ordered. One shipping unit can contain one or more single products. When placing an order, for the quantity please enter single or multiples of a shipping unit.

Download Data

File	
	User instruction TYREinflate 200
	Product movie TyreInflate How to Video (EN)
	Product movie TyreInflate 200 Product Video (EN)
	Video OSRAM TYREinflate 200: Rapid tyre inflator with wind-up cable
	Video OSRAM TYREinflate How To: Change your vehicle's tyre pressure easily

Safety advice

Product won't exceed noise levels of more than 90 dB

Product datasheet

Legal advice

CE and EAC compliant

* for precise conditions please refer to: www.osram.com/am-guarantee

** based on inflating a 13" tyre from flat to 2.41 BAR

Application advice:

For more detailed application information and graphics please see product datasheet.

Disclaimer:

Subject to change without notice. Errors and omission excepted. Always make sure to use the most recent release.

Application advice

For more detailed application information and graphics please see product datasheet.

Disclaimer

Subject to change without notice. Errors and omission excepted. Always make sure to use the most recent release.

The OSRAM logo is displayed in a bold, orange, sans-serif font.